

## 垂直真空接管型 (不带缓冲) EZPT系列



接管方式/ Joint thread	外螺纹/ Male thread
真空入口/ Vacuum inlet	垂直方向/ Vertical
安装连接方式/ Installation connection mode	利用真空接管/ Vacuum thread.



接管方式/ Joint thread	内螺纹/ Female thread
真空入口/ Vacuum inlet	垂直方向/ Vertical
安装连接方式/ Installation connection mode	利用真空接管/ Vacuum thread.

EZPT系列 (不带缓冲) 型号/EZPT series code(without buffer)

EZPT 02 U N

A5

请参阅吸盘型号/  
Refer to the pad code

真空入口/Vacuum inlet  
见下表/See following table

EZP系列之外型尺寸图  
Outline drawing(EZP series)

	符号/Symbol	软管/外螺纹 Tube/Male thread	2 ~ 8	10 ~ 16	20 ~ 32
外螺纹/ Male thread	A5	M5 x 0.8			
	A6	M6 x 1			
	A8	M8 x 1			
内螺纹/ Female thread	B4	M4 x 0.7			
	B5	M5 x 0.8			
	B6	M6 x 1			
	B8	M8 x 1.25			
	B01	1/8			

### 外形尺寸图(毫米)

适用吸盘直径/  
Applicable pad diameter  
2 ~ 8

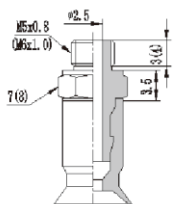

适用吸盘直径/  
Applicable pad diameter  
10 ~ 16

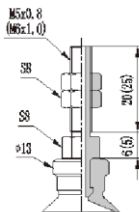

适用吸盘直径/  
Applicable pad diameter  
20 ~ 32

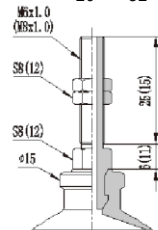

适用吸盘直径/  
Applicable pad diameter  
2 ~ 8

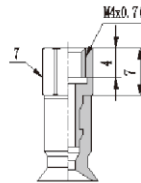

适用吸盘直径/  
Applicable pad diameter  
10 ~ 16

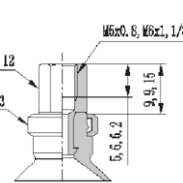

适用吸盘直径/  
Applicable pad diameter  
20 ~ 32

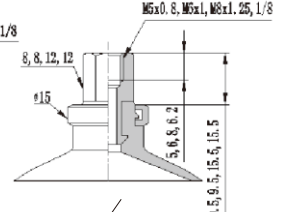

各类吸盘尺寸图见EZP系列之外型尺寸图/  
Pad dimension as EZP outline drawing

各类吸盘尺寸图见EZP系列之外型尺寸图/  
Pad dimension as EZP outline drawing